

EXC-113SD

EXC-SERIES

SPECIFICATION

TAPE WIDTH	1 1/2", 2"
BELT SPEED	23 METERS/MINUTE
CAPACITY	(L) 120mm - □ (W) 110mm - 500mm, (H) 120mm - 500mm
POWER SUPPLY	100/110/220/230/240V., 50Hz/60Hz., 1-Phase
POWER CONSUMPTION	450W

OPTIONS

- 3" Tape head
- DUAL TAPE HEADS

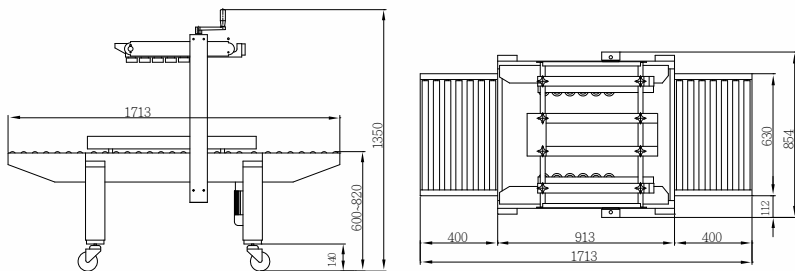

 **GS PACKAGING**

مؤسسة فصول الخليج لمعدات وأدوات التغليف
GULF SEASON STRAPPING & PACKAGING SYSTEMS

Dammam Head Office: Tel: +966 (13) 847 3734 / 847 3735, Fax: +966 (13) 847 3740
Riyadh Branch: Tel: +966 (11) 438 9060, Fax: +966 (11) 438 9061
Jeddah Branch: Tel: +966 (12) 608 4832, Fax: +966 (12) 608 4835
Website: www.gspackaging.net
E-mail: sales@gspackaging.net, info@gspackaging.net